

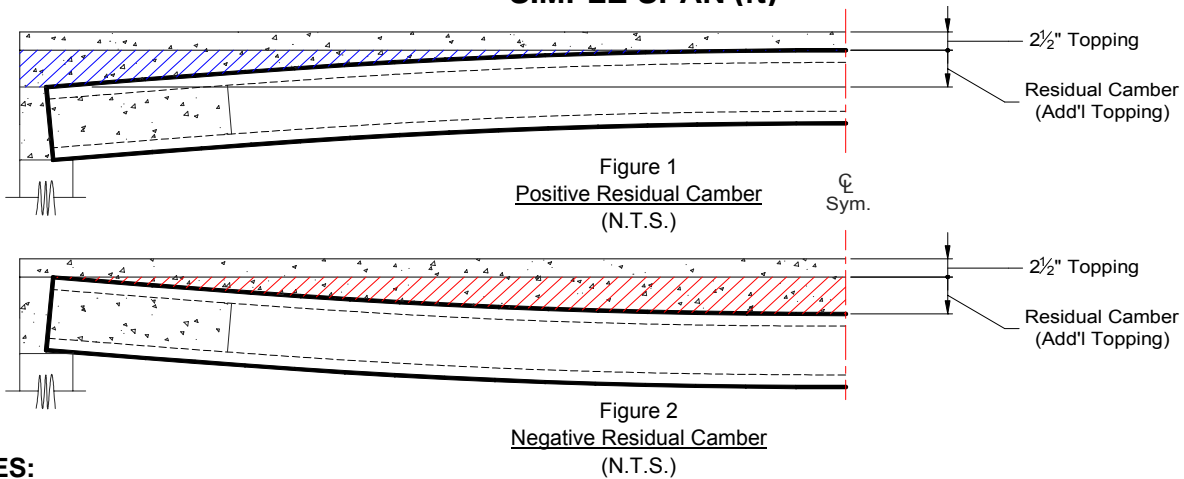

# ESTIMATED RESIDUAL CAMBER CONTOURS

## 8" HOLLOW CORE SLAB

### COMPOSITE WITH 2½" CONCRETE TOPPING (4,000 psi)

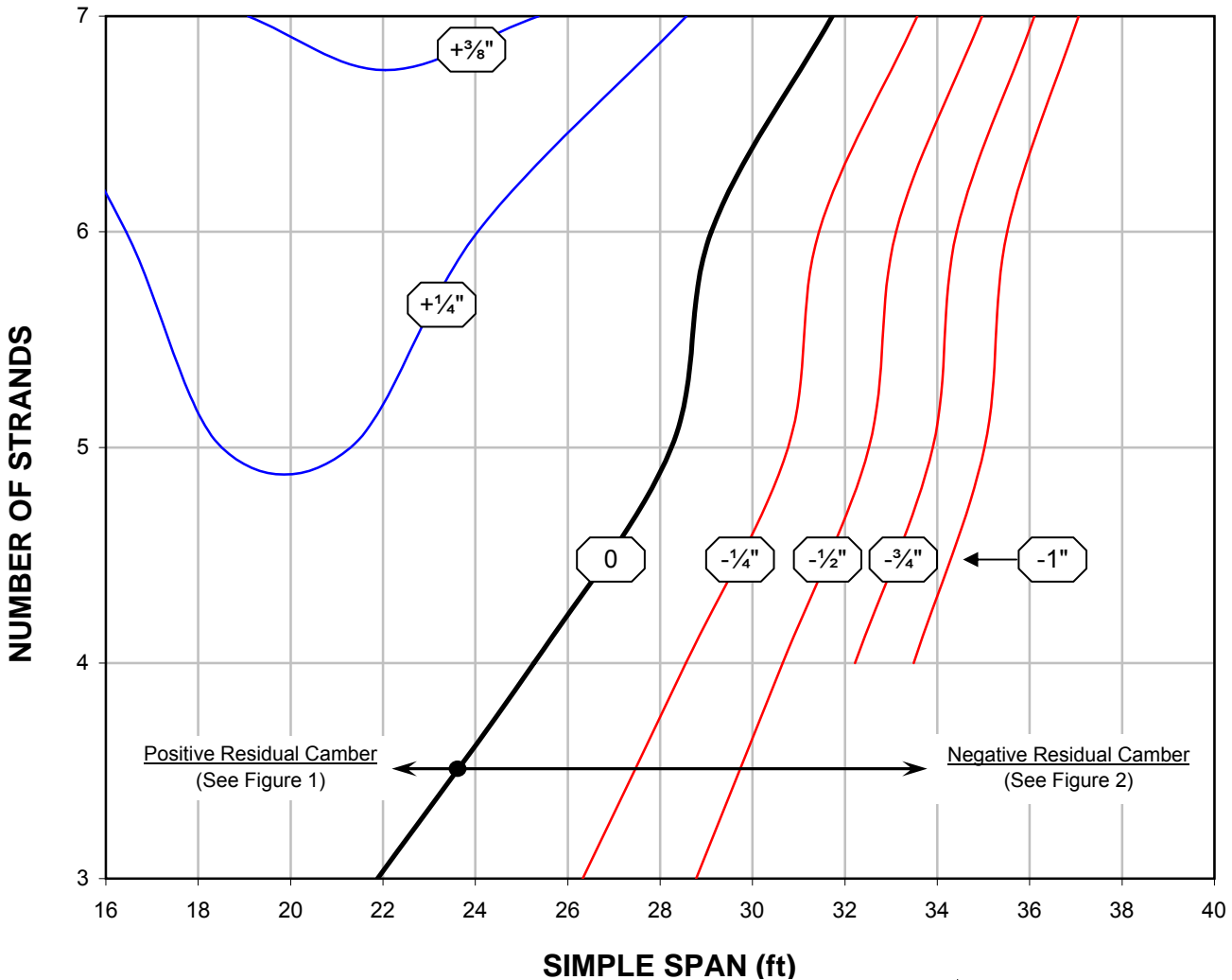

**NOTES:**

1. Residual Camber is defined as the camber remaining in the hollow core slabs just after the topping slab has been placed. The contours shown above reflect the upward deflection due to prestress force, downward deflection due to the hollow core slab self-weight and downward deflection due to the plastic (wet) topping weight.



# ESTIMATED RESIDUAL CAMBER CONTOURS

## 12" HOLLOW CORE SLAB

### COMPOSITE WITH 2½" CONCRETE TOPPING (4,000 psi)

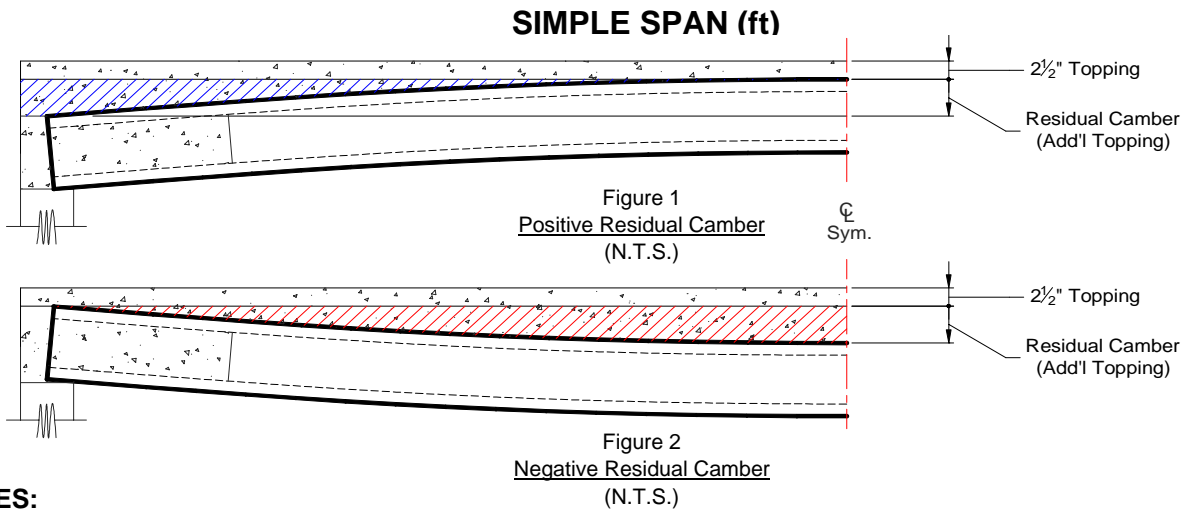
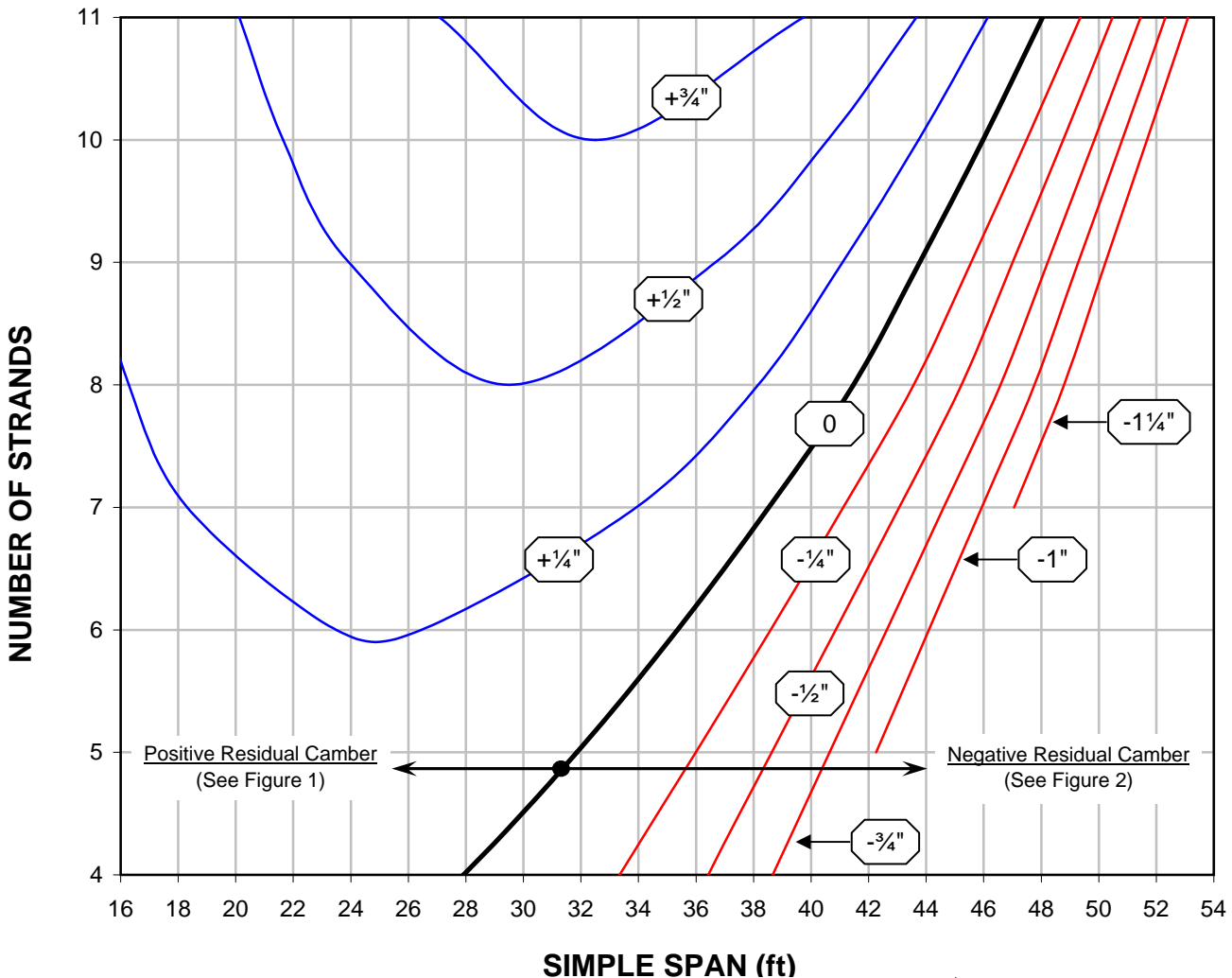

**NOTES:**

1. Residual Camber is defined as the camber remaining in the hollow core slabs just after the topping slab has been placed. The contours shown above reflect the upward deflection due to prestress force, downward deflection due to the hollow core slab self-weight and downward deflection due to the plastic (wet) topping weight.